

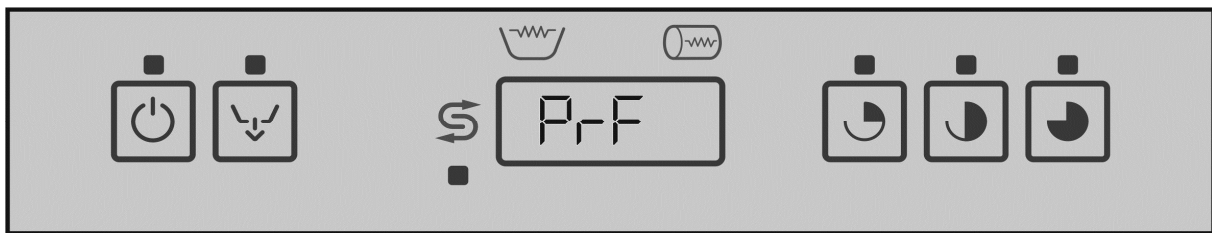

PROFESSIONAL DISHWASHER

EN



Summary

| | | |
|-------|--|----|
| 1 | PRECAUTIONS FOR SAFETY AND USE | 2 |
| 1.1 | Trademark | 2 |
| 1.2 | Name and address of manufacturer or distributor | 2 |
| 1.3 | Declaration of conformity to product standards..... | 2 |
| 2 | TECHNICAL DATA | 3 |
| 3 | INSTALLATION AND POSITIONING..... | 6 |
| 4 | INSTRUCTIONS FOR TECHNICAL STAFF..... | 6 |
| 4.1 | Plumbing hookup..... | 6 |
| 4.2 | Electrical connection | 7 |
| 5 | FIRST START-UP | 7 |
| 5.1 | Using the water softener (on models with this feature only)..... | 8 |
| 6 | SET-UP (Authorised technical staff only)..... | 9 |
| 6.1 | Contents of display | 10 |
| 6.2 | Note on display of temperatures | 10 |
| 6.3 | Parameter programming procedure (setup)..... | 10 |
| 6.4 | Modifiable parameters..... | 11 |
| 6.5 | Adjusting detergent and rinse aid dispensing (only available on certain models)..... | 11 |
| 6.5.1 | Rinse aid – Grams/liter dosage (depends on model)- The display reads “r” | 11 |
| 6.5.2 | Detergent - Grams/liter dosage (depends on model) - The display reads “dE” | 11 |
| 6.6 | Starting the peristaltic pumps in manual mode – rapid filling of detergent and rinse aid circuit | 12 |
| 6.7 | Adjusting the regeneration frequency (models with softener only)..... | 12 |
| 6.8 | Mains water hardness setting table | 12 |
| 6.9 | Extra rinse option (long rinse). - Display reads “E.r” | 12 |
| 6.10 | "Clean water cycle" option - Display reads “CL” | 13 |
| 6.11 | “Thermostop” option - Display reads “LS” | 13 |
| 6.12 | Fast/eco starting option - Display reads “Fi” | 13 |
| 7 | MALFUNCTIONS SHOWN ON THE DISPLAY (FOR THE TECHNICIAN)..... | 13 |
| 8 | INSTRUCTIONS FOR THE USER..... | 15 |
| 8.1 | Control panel..... | 15 |
| 8.2 | Before washing | 16 |
| 8.3 | First use each day (tank and boiler empty) | 17 |
| 8.4 | Choosing the program | 18 |
| 8.5 | Changing the program | 18 |
| 9 | MAINTENANCE AND CLEANING..... | 20 |

| | | |
|-----|--|----|
| 9.1 | Daily cleaning of filters | 21 |
| 9.2 | Routine inspection of the spray arms (once a week) | 22 |
| 9.3 | Lengthy periods out of use | 23 |
| 10 | TROUBLESHOOTING | 23 |
| 11 | MALFUNCTIONS SHOWN ON THE DISPLAY (FOR THE USER) | 25 |

SMEG Thanks you for choosing one of its products.

Read all the instructions in this manual carefully to become familiar with the right conditions for the proper use of your dishwasher.

TECHNICAL INSTRUCTIONS

| | |
|--|--|
| | <p>These are intended for the qualified staff who are to install, commission and test the appliance and carry out any servicing and repairs.</p> |
|--|--|

INSTRUCTIONS FOR THE USER

| | |
|--|---|
| | <p>These provide recommendations for use, a description of the controls and the correct procedures for cleaning and maintaining the dishwasher.</p> |
|--|---|

1 PRECAUTIONS FOR SAFETY AND USE

1.1 Trademark

SMEG

1.2 Name and address of manufacturer or distributor

Smeg S.p.A.

Via Leonardo da Vinci, 4 - 42016 Guastalla (RE) Tel. +39 0522 8211 - Fax + 39 0522 821453

internet: www.smegfoodservice.com, email : fooddservice@smeg.it

Info :

INFORMATION AND SERVICE FOR SMEG PROFESSIONAL DISHWASHERS

Our Sales Department staff will be able to provide you with information about prices and special offers.

Our After-Sales Department will be able to provide you with guidance about keeping your appliance functioning correctly and put you in touch with your nearest authorised Service Centre. Our entire product offering can be viewed at:

1.3 Declaration of conformity to product standards

THIS APPLIANCE IS TAGGED UNDER EUROPEAN DIRECTIVE 2002/96/EC ON WASTE ELECTRICAL AND ELECTRONIC EQUIPMENT (WEEE). BY MAKING SURE THAT THIS PRODUCT IS DISPOSED OF CORRECTLY THE USER HELPS TO PREVENT POTENTIAL DETRIMENTAL EFFECTS ON HEALTH AND THE ENVIRONMENT. WHEN DECOMMISSIONING THE APPLIANCE COMPLY WITH THE LOCAL WASTE DISPOSAL REGULATIONS. FOR FURTHER INFORMATION ON THE TREATMENT, RECOVERY AND RECYCLING OF THIS PRODUCT, CONTACT THE COMPETENT LOCAL OFFICE, THE DOMESTIC WASTE COLLECTION SERVICE, OR THE SHOP WHERE THE PRODUCT WAS PURCHASED. THE APPLIANCE MUST BE GROUNDED AS REQUIRED BY ELECTRICAL EQUIPMENT SAFETY STANDARDS. THE DISHWASHER IS INTENDED FOR PROFESSIONAL USE ONLY AND MUST ONLY BE USED BY AUTHORISED STAFF. IT IS DESIGNED TO WASH TABLEWARE (PLATES, CUPS, BOWLS, OVEN DISHES AND CUTLERY) AND SIMILAR ITEMS IN THE RESTAURANT AND INSTITUTIONAL CATERING SECTOR, AND COMPLIES WITH THE INTERNATIONAL STANDARDS ON ELECTRICAL AND MECHANICAL SAFETY (CEI-EN-IEC 60335-2-58/61770) AND ELECTROMAGNETIC COMPATIBILITY (CEI-IEC-EN 55014-1/-2, 61000-3;4, 50366). THE MANUFACTURER DECLINES ALL RESPONSIBILITY FOR INJURY OR DAMAGE CAUSED BY FAILURE TO COMPLY WITH THE ABOVE REGULATIONS OR DERIVING FROM INCORRECT USE, TAMPERING WITH EVEN JUST ONE PART OF THE APPLIANCE AND THE USE OF NON-ORIGINAL SPARE PARTS.

| | |
|--|---|
| | THIS MANUAL IS AN INTEGRAL PART OF THE DISHWASHER AND MUST ALWAYS BE KEPT INTACT TOGETHER WITH THE APPLIANCE. |
| | POSITIONING, HOOKUP, COMMISSIONING, TROUBLESHOOTING AND REPLACING THE POWER CABLE MUST BE CARRIED OUT BY QUALIFIED STAFF. |
| | THE APPLIANCE MUST BE GROUNDED AS REQUIRED BY ELECTRICAL EQUIPMENT SAFETY STANDARDS. |
| | THE SYMBOL OF THE RUBBISH BIN WITH A BAR ACROSS IT ON THE PRODUCT OR IN THE TECHNICAL DOCUMENTATION INDICATES THAT THIS PRODUCT MUST NOT BE TREATED AS ORDINARY DOMESTIC WASTE BUT MUST BE CONSIGNED TO THE SPECIAL COLLECTION POINT FOR THE RECYCLING OF ELECTRICAL AND ELECTRONIC EQUIPMENT. |
| | NEVER PLACE SOLVENTS SUCH AS ALCOHOL OR TURPENTINE , WHICH MIGHT CAUSE AN EXPLOSION, INSIDE THE APPLIANCE. NEVER LOAD DISHES DIRTY WITH ASH, WAX OR PAINTS. |
| | NEVER USE THE DISHWASHER OR ANY PART OF IT AS A LADDER, SUPPORT OR STAND FOR PEOPLE, ANIMALS OR ANY OBJECT. LEANING OR SITTING ON THE OPEN DOOR OF THE DISHWASHER MIGHT CAUSE IT TO TIP OVER, PUTTING PEOPLE IN DANGER. NEVER LEAVE THE DISHWASHER DOOR OPEN SINCE PEOPLE MIGHT TRIP OVER IT. |
| | DO NOT DRINK ANY WATER LEFT IN THE DISHES OR DISHWASHER AT THE END OF THE WASHING PROGRAM. |
| | THE APPLIANCE IS NOT SUITABLE FOR USE BY JUVENILES OR PERSONS WITH REDUCED PHYSICAL, SENSORIAL OR MENTAL CAPACITIES , OR THOSE WITHOUT THE NECESSARY KNOWLEDGE AND EXPERIENCE. SUCH PERSONS MAY ONLY USE THE APPLIANCE UNDER THE SUPERVISION OF A PERSON RESPONSIBLE FOR THEIR SAFETY. |

2 TECHNICAL DATA

| | | |
|--|-----------|-------------------|
| Water intake pressure | kPa (bar) | 250-600 (2,5 ÷ 6) |
| Water intake pressure (with rinse pump) | kPa (bar) | 100-600 (1 ÷ 6) |
| Water intake temperature | °C | 15°C – 60°C |
| Intake water hardness (models with softener <60°f) | °f | <15°f |
| Rinse cycle water consumption | l | 3,2 |
| Boiler capacity | l | 6 |
| Tank capacity | l | 13 |
| Duration standard cycles with water at 50°C | s | 90/120/180 |
| Noise level | dB(A) | < 60 |
| Degree of protection | IPX | 4 |
| Net weight | Kg | 32/36 |
| Power supply cable type | ◀HAR▶ | H07RN-F |

| VOLTAGE | TANK HEATING ELEMENT | MOTOR | BOILER | TOTAL POWER RATING | POWER CABLE | |
|-----------------------|----------------------|--------|--------|--------------------|-------------|--------------------------------------|
| 400 V 3N~ / 50Hz / PE | 2,0 kW | 0,7 kW | | 4,96 kW | 5,7 kW | H07RN- F 5G x 2,5 mm ² |
| 230 V 3~ / 50Hz / PE | | | | 4,96 kW | 5,7 kW | H07RN- F 4G x 2,5 mm ² |
| 230 V 1N~ / 50Hz / PE | | | | 1,67 kW | 2,7 kW | H07RN- F 3G x 1,5 mm ² |
| 230 V 1N~ / 50Hz / PE | | | | 2,50 kW | 3,2 kW | H07RN- F 3G x 2,5 mm ² |
| 230 V 1N~ / 50Hz / PE | | | | 3,33 kW | 4,0 kW | H07RN- F 3G x 4,0 mm ² |

| | | | |
|--|--|--|--|
| Fuse 16A Models with Schuko plug | | Fuse 13A Models with UK plug | |
|--|--|--|--|

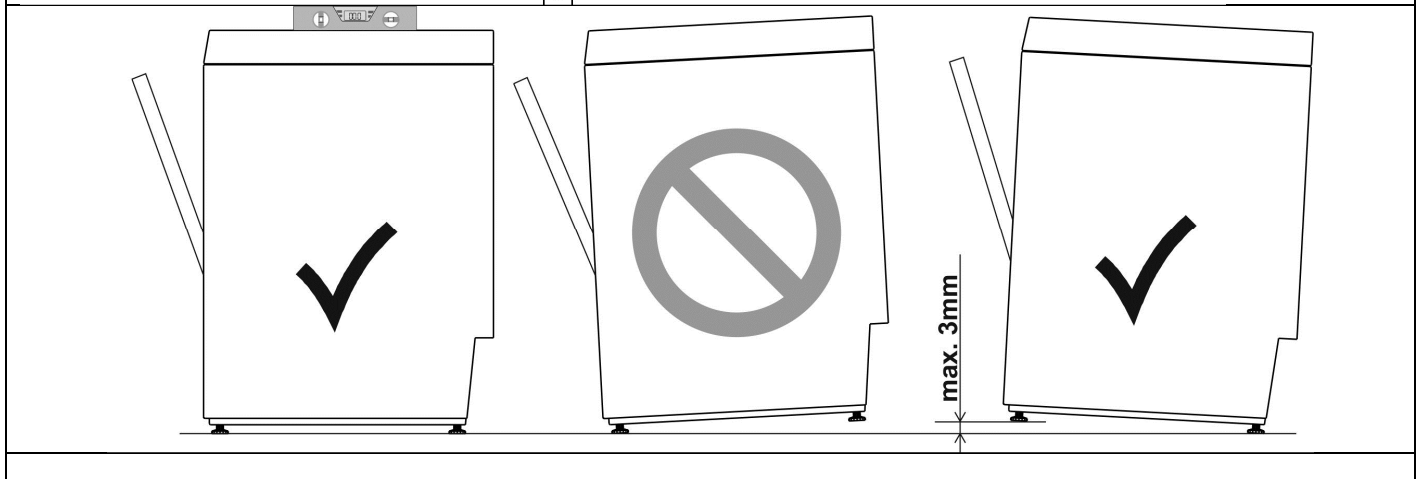
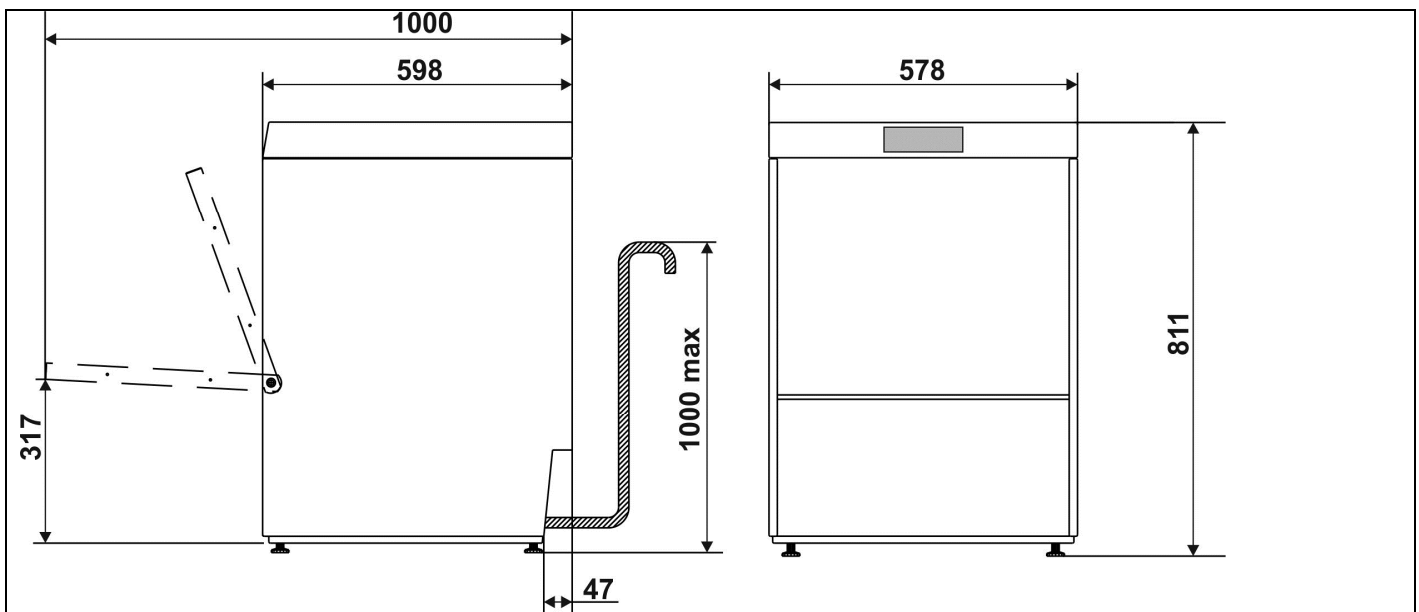

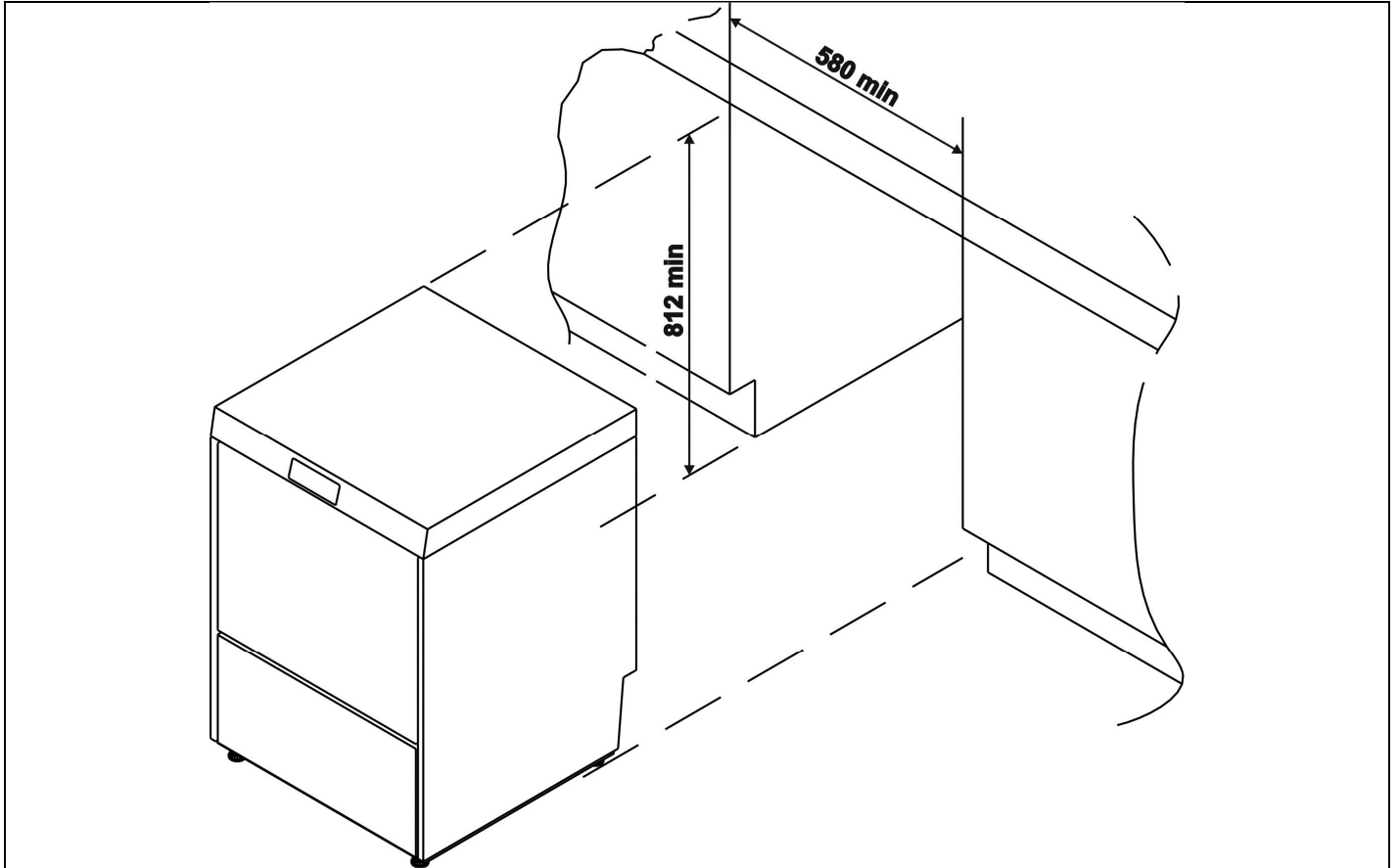

| | | |
|------------|------------------------|--|
| R | REAR INFERIOR PANEL | |
| C | CHARGING HOSE | |
| Q ↓ | EARTH TERMINAL | |
| E | POWER SUPPLY CABLE | |
| P | PERISTALTIC PUMP TUBES | |
| S | WASTE PIPES | |

3 INSTALLATION AND POSITIONING

INSTALLATION and POSITIONING

Bring the dishwasher to the installation site, remove the packaging and check the appliance and components for damage; any damage found must be reported to the transporter in writing. The packaging components (plastic bags, expanded polystyrene, nails, etc.) must not be left within reach of children and pets since they are potentially dangerous. All packaging materials used are environment-friendly. They can be kept without constituting any hazard, or may be disposed of at a specialist waste disposal centre. The plastic components suitable for recycling are marked as follows: PE polyethylene: external packaging film, bag containing the instructions, protective bags. PP polypropylene: straps. PS expanded polystyrene: corner guards, top of packaging. Wooden and cardboard components can be disposed of in accordance with the relevant regulations.

When the product is decommissioned it must not be dumped in the environment; it must be disposed of in accordance with the relevant regulations. All metal parts are in stainless steel and can be removed. The plastic parts are marked with the symbol identifying the material used.

Positioning



Warning: the indoor system and premises in which equipment for institutions is installed must comply with the relevant regulations.

The manufacturer declines all liability for direct or indirect injury or damage deriving from failure to comply with these regulations. Before installation, check that there are no objects or materials near the machine which may be damaged by steam or splashes of washing solution, or that such items are suitably protected. Place the dishwasher in the chosen point and remove the protective film. Level the dishwasher (with the aid of a spirit level) on its adjustable feet to ensure that it is stable; all other mounting solutions must be approved by the manufacturer.

4 INSTRUCTIONS FOR TECHNICAL STAFF

4.1 Plumbing hookup



PLUMBING HOOKUP

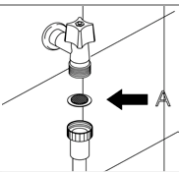

The water pipelines and electricity supply cable lead out of the bottom right-hand corner of the appliance. Connect the water intake hose to a connector with $\frac{3}{4}$ " gas threaded fitting, fitting the filter A provided (in models with Acquastop, the filter and ring-nut form a single unit). The connection to the water mains must only be made with new hoses; the use of old or worn hoses is not permitted.

The dynamic **water supply pressure** must be between **1 and 6 bar** (according models); if it is higher, installation of a pressure reducer is necessary. If the pressure is **less than 2.5 bar** (models without rinse pump) it might be necessary to fit a special pump on the appliance to ensure optimal performance. **Contact the After-Sales Service.** It is essential to fit a main stop tap on the water intake deliver pipeline; the tap must be accessible after installation of the appliance, so do not install it behind the dishwasher. The stated cycle duration applies to appliances supplied with **hot water >50°C<60°C**. If the dishwasher is supplied with cold water, the cycle duration might increase depending on the intake water temperature. **Drainage:** The dishwasher **is fitted with a drain pump** and can operate with drain connections on the floor or wall. Refer to the connection diagram for the maximum permitted height of wall drains – (see TECHNICAL DATA)



Warning: make sure that the intake and drain hoses are not bent, constricted or crushed after installation.

When installing the drain hose to a siphon with valve, the maximum height of the drain outlet is reduced to 600 mm.

4.2 Electrical connection

| | |
|--|--|
| | <p>The dishwasher and any additional equipment must be connected to the electrical system by authorised, skilled staff, in accordance with the relevant regulations; also comply with the technical instructions for the connection. The total rated power is stated on the appliance's technical data plate. The electrical protection devices fitted for the dishwasher must serve this appliance only. The user must have a master switch and a differential safety breaker, with rating suitable for the appliance's characteristics, installed on the electricity supply line in accordance with the relevant regulations. These switches must be installed close to the dishwasher, be easily accessible after installation, and provide complete disconnection from the electrical mains in overvoltage class III conditions.</p> |
| | <p>Warning! The dishwasher is always powered up unless the master switch is turned off.</p> |
| | <p>Connect the appliance to the user's earth system. The  terminal for the connection is in the bottom right-hand corner of the appliance. The earth wire (PE) is yellow-green in colour, the neutral wire (N) is blue and the live wires (L1, L2, L3) are black, grey and brown. In the event of single-phase connection (230V-1N~), the connection to the electrical mains must be made using a cable with plug compliant with the relevant regulations. According to the target market, the dishwasher can be equipped with a cable fitted with plug.</p> |
| | <p>THE POWER SUPPLY CABLE, IF FITTED, MUST BE REPLACED BY THE MANUFACTURER OR AN AUTHORISED SERVICE CENTRE IN ACCORDANCE WITH THE TECHNICAL DATA SPECIFIED ON THE WIRING DIAGRAM SUPPLIED WITH THE APPLIANCE, TO PREVENT ALL RISKS.</p> |

5 FIRST START-UP

First start-up

The electrical protection system must undergo a functional test before the appliance is put into operation.

The appliance must be installed and/or inspected by qualified staff, who will start it up for the first time and provide the relevant operating instructions.

Preparing for use (important)

The rinse aid dispenser is fitted on all models, the detergent dispenser only on some.

If both dispensers are present put the external detergent and rinse aid containers in place and insert the respective intake hoses on the rear of the appliance into them. Red hose: detergent, blue hose: rinse aid

| | |
|--|---|
| | <p>Before inserting the hoses into the containers, fit the weights (needed to ensure that they always draw in liquid from the bottoms of the containers) and the filters onto their ends as shown. If the detergent dispenser is not factory-fitted, it can be retrofitted after ordering the relative kit.</p> |
|--|---|



IMPORTANT

Whenever the type of detergent or rinse aid is changed, it is **ABSOLUTELY ESSENTIAL** to flush out the peristaltic pumps by placing the external intake pipes in water for a few cycles. Always use only products specifically recommended for use in a professional dishwasher. Failure to comply with this recommendation leads to **forfeiture of the warranty** entitlement on the appliance's water system. Replacement of the **internal tube** of the detergent and rinse aid peristaltic pumps is **recommended every 12 months or 15.000 wash cycles**, by the After-Sales Service.

5.1 Using the water softener (on models with this feature only)



The quantity of lime in the water (which indicates its hardness) causes whitish marks on dry dishes and dishes also tend to lose their shine over time. The dishwasher is equipped with an automatic water softener which removes the substances that cause hardness from the water with the aid of regenerating salt.



The first time the dishwasher is used, a litre of water must be poured into the tank with the salt. Whenever the tank is filled, always take care to ensure that the cap is firmly closed. The mixture of water and detergent must not get into the salt tank, as this would impair operation of the regeneration system. In this case warranty cover will be forfeited.

6 SET-UP (Authorised technical staff only)

| | |
|--|--|
| | <p>Set-up During first start-up, the functions/parameters listed below must be set or adjusted.</p> |
|--|--|

Control Panel

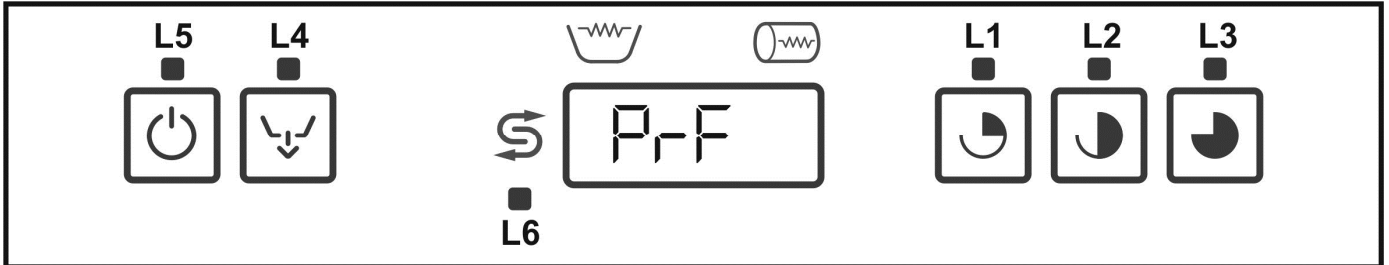

Key to Symbols

| | |
|------|---|
| | On/off button |
| | Total pump-out (tank -boiler) button |
| | Regenerating salt symbol (only if softener is fitted) |
| | Short programme button |
| | Medium programme button |
| | Long programme button |
| L1 ○ | Short programme Led |
| L2 ○ | Medium programme Led |
| L3 ○ | Long programme Led |
| L4 ○ | Drainage Led |
| L5 ○ | Appliance on Led |
| L6 ○ | No salt Led (only if softener is fitted) |

Key to messages on display

| | |
|--------------------|---|
| CLOSE | Close the door |
| FILL | Machine preparing for cycle |
| End | End of operation requested |
| PrF 400/500/CAP | Machine model (viewed when the machine is started with master switch) |
| F x xx r xxx | Version/revision of the installed firmware. (viewed when the machine is started with master switch, after the model code) |
| UnLoad | Pump-out |
| OFF | Energized machine OFF |

Using the buttons

| Button | Short press | Pressed for 2" | Pressed for 5" | Long press, release, press again |
|--------|---|--|--------------------------------|---|
| | Display temperatures Boiler and tank | On/OFF | | Door open and machine OFF . Long press >>> display reads "- -" >>> release and press again: Access Setup Menu (1) |
| | Scroll through Setup options (2) | | Start Pump-out | Total pump-out (tank+boiler) |
| | Set Short Programme | Start Short Programme | | |
| | Set Medium Programme | Start Medium Programme | | |
| | Set Long Programme | Start Long Programme | | |
| | Set P0 (Empty tank) | | Start P0 Door closed | |
| | | Peristaltic pumps in Manual mode to prime pipes | | Reset to DEFAULT parameters (1) Technician user only |

1) Restores the default parameters, for new settings see point (6.3)

A series of operations can be carried out when the dishwasher is first installed to customise it to the user's requirements.

6.1 Contents of display

The display provides the following information:

- Machine off but energized: **OFF**
- Machine on and ready for use: **End/P1-P2-OP3**
- Wash phase: ||| ||| ||| |||
- Programming phase: See parameter programming section
- Error message: See error messages section

6.2 Note on display of temperatures

Temperatures shown on the display might not indicate the actual temperature in the tank and/or boiler during heating - wait about 1' after the heating elements switch off to see the real temperature.

6.3 Parameter programming procedure (setup)

To modify the parameters, proceed as follows starting with the appliance in "**OFF**" status with the door open.

1) Switch the appliance using the On/OFF button

2) Press and hold the button until the display shows "- -", release and press again.

3) Press the pump-out button to scroll through the parameters for modification

4) Modify the parameter by pressing button P1

5) During setup operations, the description and value of the parameter alternate on the display.

6) Select the other parameters for modification in the same way and proceed as described above

7) To exit the setup menu press and hold until the display shows "OFF", press P2 or P3 or wait at least 3 minutes without pressing any key; in this way the machine automatically exits the setup menu.

6.4 Modifiable parameters

This table lists the model choice or programme and temperature option parameters.

| Display | Settings available | Description |
|---------|--|--|
| °b | From 85° to 71° | Boiler temperature |
| °t | From 62° to 52° | Tank temperature |
| ri | 0 – 2 gr/lit (in steps of 0,1) | Rinse aid batching |
| dE | 0-10 gr/lit (0-3 in steps of 0,2; 3-10 in steps of 1,0) | Detergent batching |
| St | On - OF | Auto-start: washing programme starts when door is closed On enabled OF disabled |
| HA | H0 – H6 | Water hardness setting (see table 6.8 in the following pages) |
| Er | On-OF | Prolonged rinse at the end of the washing cycle (+8"). |
| CL | On-OF | Clean water cycle. On enabled OF disabled |
| TS | On - OF | Thermostop On enabled OF disabled |
| Fi | FS-EC | Starting the machine in FAST or ECO mode (models without rinsing pump only) |
| Sr | - | Access Service menu (for Authorised Engineer only) |

6.5 Adjusting detergent and rinse aid dispensing (only available on certain models)

6.5.1 Rinse aid – Grams/liter dosage (depends on model)- The display reads “r”

| | | |
|--|--|--|
| | <p>Every time is pressed, the value increases of 0,1 g/l up to a max. of 2 g/l.</p> <p>Default: 1,2 g/l.</p> | |
|--|--|--|

6.5.2 Detergent - Grams/liter dosage (depends on model) - The display reads “dE”

| | | |
|--|--|---|
| | | |
| <p>Factory-set default value = 2 gr/lit.</p> | <p>From 0,0 g/l to 3,0 g/l every time is pressed, the value increases of 0,2 g/l.</p> | <p>Beyond 3,0 g/l every time is pressed, the value increases 1,0 g/l up to 10,0 g/l (maximum value).</p> |

6.6 Starting the peristaltic pumps in manual mode – rapid filling of detergent and rinse aid circuit

Energized dishwasher and full tank: press for 5 seconds buttons **P2** + **P3** simultaneously.

The peristaltic pumps work until P1 or P2 are pressed again; during the procedure the indicator lights stay on and the display shows “rd”. The rinse aid circuit is filled in 7 minutes, the detergent circuit is filled in 2 minutes.

Since the pumps work at the same time, only the rinse aid (blue tube in the rinse aid jerrycan) must be withdrawn for 5 minutes, then the detergent (red tube in the detergent jerrycan) is withdrawn too for the last two minutes.

6.7 Adjusting the regeneration frequency (models with softener only)

See appliance setup menu (point 6.4)

| | |
|--|--|
| | With values over 60°dF /33°dH an external water treatment device must be used and the regeneration frequency must be set at H0 |
|--|--|

6.8 Mains water hardness setting table

After a number of washing cycles corresponding to the set water hardness has been started, the dishwasher starts automatically the resin regeneration cycle, that lasts about 90 seconds. During this phase the machine load or unloads automatically, even though it isn't performing a washing cycle.

| Hardness (°dH German degrees) | Hardness (°dF French degrees) | Setting level | Resin regeneration interval: approximate number of wash cycles |
|-------------------------------|-------------------------------|---------------|--|
| Regeneration off | | HA: 00 | ----- |
| 8.5 | 15 | HA: | 152 |
| 11 | 20 | HA: 02 | 128 |
| 17 | 30 | HA_03 default | 74 |
| 22.5 | 40 | HA: 04 | 37 |
| 28 | 50 | HA: 05 | 27 |
| 33.5 | 60 | HA: 06 | 11 |

6.9 Extra rinse option (long rinse). - Display reads “E.r”

| | |
|--|---|
| | <p>Rinse is 8" longer than the standard in every washing cycle.</p> <p>Press to enable (On)/disable (OF)</p> |
|--|---|

6.10 "Clean water cycle" option - Display reads "CL"

| | |
|---|---|
| | <p>With this option clean water is used for every washing. At each cycle, the washing water is completely drained and it is replaced with clean water from rinsing.</p> |
| <p>Press to enable (On)/disable (OF)</p> | |

6.11 "Thermostop" option - Display reads "tS"

| | |
|---|---|
| | <p>"on" = the minimum temperature of rinse as set, independently from the intake water temperature, the nominal duration of cycle may be extended by a few seconds. "off" = the minimum temperature of rinse may be a few degrees lower than the set one, if hot intake water is not used.</p> |
| <p>Press to enable (On)/disable (OF)</p> | |

6.12 Fast/eco starting option - Display reads "Fi"

| | |
|---|---|
| | <p>Fast (FS): it allows to start the machine in less time than the standard; it involves a greater water consumption at the first start. Eco starting (EC): the machine starts in standard time, without any additional water consumption.</p> |
| <p>Press to enable (On)/disable (OF)</p> | |

7 MALFUNCTIONS SHOWN ON THE DISPLAY (FOR THE TECHNICIAN)

The dishwasher is able to identify a number of malfunctions and show them on the display. If the problem persists after the dishwasher has been switched off and back on, proceed as described below:

| | | |
|-------|--------------------------------------|--|
| Er 04 | Tank temperature probe malfunction | Tank temperature probe disconnected or not working. |
| Er 05 | Tank water filling malfunction | <ul style="list-style-type: none"> - The tank wasn't filled in the expected time: check the water supply tap, the dynamic supply pressure, cleanliness of the inlet water filter, cleanliness of the rinse nozzles, any damage of the water charging hose. If the problem still occurs during the "FILL": - Work level tank pressure switch damaged (it always detects "empty": check if the tank safety pressure switch starts operating). - Leakage from the tube connected to the air trap; if the problem is not solved, it occurs during the work program. - vent valve of the drain pipe obstructed with dirt: with siphonage, the tank gets completely empty at the end of a washing program. |
| Er 06 | Water pump-out malfunction | <p>Check:</p> <ul style="list-style-type: none"> - filter cleanliness; obstructions, bending and narrowing of the drain pipe. - possible obstructions of the drain pump (blocked with a foreign body). <p>In case the problem is not solved, please contact the After-Sales Service.</p> |
| Er 23 | Boiler does not heat up as expected. | The problem might occur because water is continually entering the tank (the causes are as for "Er 05" – see above) If the boiler heating element is damaged, this might be due to operation with no water in the boiler - the |

| | | |
|--------------|--|---|
| | | pressure switch is indicating full even with the boiler empty: - damaged boiler heating element – contactor failure - open on boiler safety thermostat side. - boiler temperature probe faulty or incorrectly positioned - motherboard relay failure, Important: If the boiler heating element is damaged, this might be due to operation with no water in the boiler, pressure switch continues to give full reading even with boiler empty: check boiler air trap and/or relative pressure switch and replace if necessary. |
| Er 24 | Boiler temperature probe malfunction | Boiler temperature probe disconnected or not working |
| Er 25 | Boiler water filling malfunction | The boiler wasn't filled in the expected time: check the water supply tap, the dynamic supply pressure, cleanliness of the inlet water filter, any damage of the water charging hose, or check the following in this order: - faulty boiler pressure switch (it always detects "empty"), - leakage or unbinding of the tube (water runs inside the tube) - menu service wrong setting " rp " |
| Er 26 | Boiler emptying malfunction | - check cleanliness of the rinse nozzles - faulty boiler pressure switch (it always detects "full") - leakage or unbinding of the tube (water runs inside the tube) - rinsing pump malfunction (if present) |
| Er 27 | Boiler emptying malfunction – with tank full Or boiler full signal on models without rinsing pump | Faulty boiler pressure switch (it always detects "full"). If this occurs in models without rinsing pump, the boiler pressure switch is wrongly detected: check settings in the service menu on entry " rp " " rp " = on for models with rinsing pump " rp " = of for models without rinsing pump |

8 INSTRUCTIONS FOR THE USER

8.1 Control panel

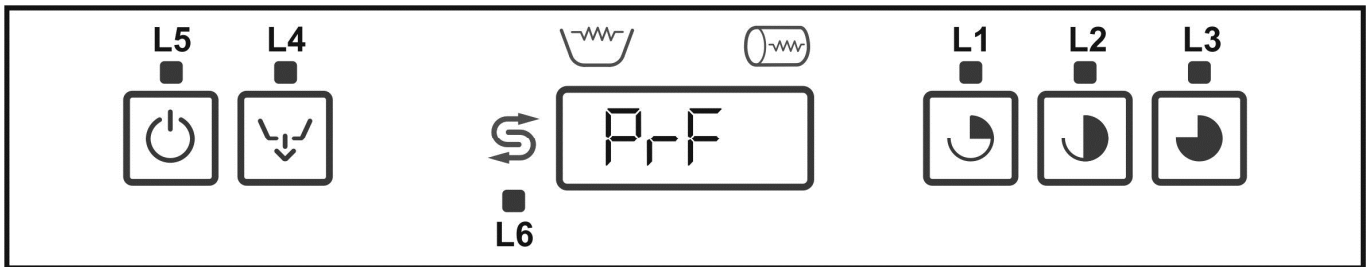

Key to Symbols

| | |
|------|---|
| | On/off button |
| | Total pump-out (tank -boiler) button |
| | Regenerating salt symbol (only if softener is fitted) |
| | Short programme button |
| | Medium programme button |
| | Long programme button |
| L1 ○ | Short programme Led |
| L2 ○ | Medium programme Led |
| L3 ○ | Long programme Led |
| L4 ○ | Drainage Led |
| L5 ○ | Appliance on Led |
| L6 ○ | No salt Led (only if softener is fitted) |

Key to messages on display

| | |
|--------------------|---|
| CLOSE | Close the door |
| FILL | Machine preparing for cycle |
| End | End of operation requested |
| PrF 400/500/CAP | Appliance model (displayed when the appliance is switched on with the master switch). |
| UnLoad | Pump-out |
| OFF | Energized machine OFF |

Using the buttons

| Button | Short press | Pressed for 2" | Pressed for 5" |
|--------|--|------------------------|---|
| | Display of temperatures in Boiler (L3) and tank (L1) | On/OFF | |
| | | | Start total drain (tank + boiler) |
| | | Start Short Programme | |
| | | Start Medium Programme | |
| | | Start Long Programme | |
| | Set P0 | | Start programme P0: emptying of tank to clean filters. Switch off and back on to allow reuse. |

8.2 Before washing

| | |
|--|---|
| | Use only detergents and rinse aids for industrial dishwashers. Do not use detergents intended for hand washing. We recommend the use of Smeg products, specially developed for this dishwasher. |
| | When topping up the tanks, take care not to swap the products; this might damage the dishwasher and cause malfunctions. |

Do not mix different detergents; this would damage the dispenser device. **Failure to comply** with this recommendation leads to **forfeiture of the warranty** entitlement on the appliance's water system. Industrial dishwasher detergents may cause serious irritation. Comply carefully with the instructions provided by the detergent producer on the pack.

Check

| | |
|---|---|
| | 1. Turn on the mains water tap (user) |
| | 2. The level of detergent and rinse aid in the containers. |
| <p>SALE SALT SEL SALZ SAL</p> | 3. That there is regenerating salt in the relative container (if fitted). |

| | |
|--|--|
| | <p>4. That the filters are in place, the spray arms rotate, and there are no foreign bodies in the dishwasher.</p> |
| | <p>5. Switch on the master switch (user): the decimal points of both digits appear on the display.</p> |

8.3 First use each day (tank and boiler empty)

| | |
|--|---|
| | <p>Door closed and master switch on ON:</p> <p>Press and hold for 2/3 seconds, Leds ON/OFF light up and the firmware version and e revision are displayed (F xxx r xxx...); FILL is displayed afterwards.</p> |
| | <p>Tank filling starts. When the tank is full the display reads "End" alternating with the last running program (End/P1).</p> |
| | <p>Load the dishes and close the door</p> |
| | <p>Select the program required by holding down one of the three buttons required for about 2"; the Led of the program flashes. During the wash, a series of vertical bars on display indicate the progress of the selected program.</p> |
| | <p>When the program is over, the program led stops flashing and stays on, the display alternates the run program and "End" (ex. P2/End).</p> |
| | <p>Unload the dishes</p> |

When the door is closed again, the system offers the last program run.

8.4 Choosing the program

| SYMBOL | PROGRAM | TYPE OF DIRT | DURATION (*) |
|--------|---------|--|--------------|
| | Short | Glasses and cups | 1'30" |
| | Medium | Glasses, cups and plates with light dirt | 2' |
| | Long | Very dirty dishes and cutlery | 3' |

(*) The cycle duration stated above is guaranteed if the appliance is connected to hot water > 50°C < 60°C. If the dishwasher is supplied with cold water, the cycle duration might increase depending on the intake water temperature and the "Thermostop" setting.



If the door is opened when a program is in progress, the program is interrupted; when the door is closed again the program must be restarted.



Power failure.
If the door is open when power is restored, the display reads "CLOSE" and "ot" flashes; the heating element stays off for the user's safety, in order to avoid the risk of burns.
Close the door to resume heating the water in the tank.

8.5 Changing the program

| | |
|--|--|
| | <p>If the master switch is not turned off, the appliance sets on the last programme performed. To change the program, press the button of the desired program, the led flashes and the display reads the program duration.</p> |
| | <p>To confirm hold down for about 2". The led flashes and the wash program starts.</p> |

If a programme is already running, it can be changed by first switching the appliance to pause status (by pressing one of the



buttons for 2") and then selecting the programme required.

BASKETS PROVIDED

The shape and material of the baskets provided with the dishwasher depend on the purchased model. Extra baskets can be purchased through the After-Sale Service. The following images are indicative.

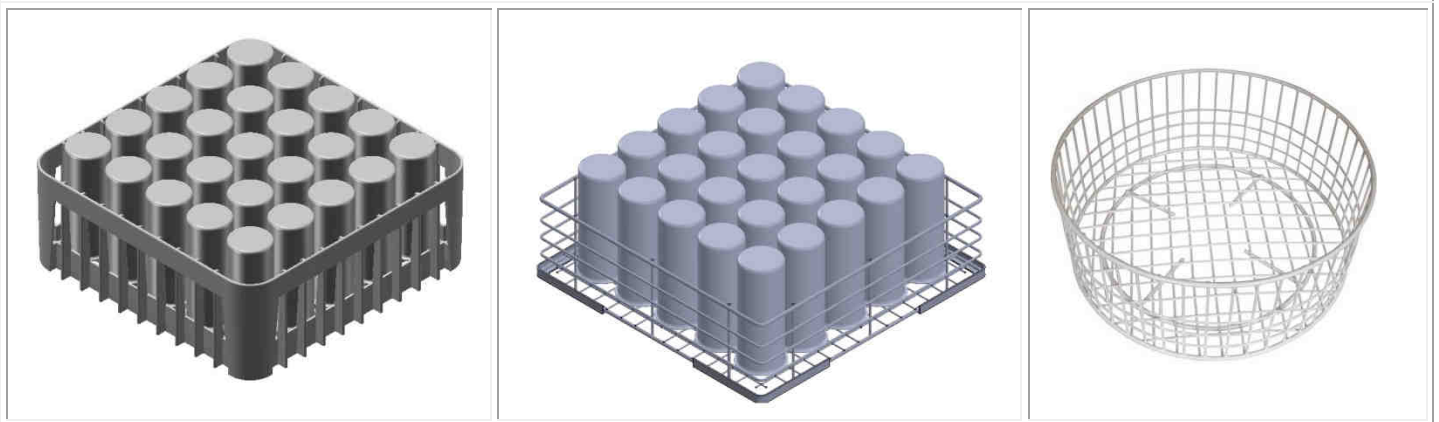

Glasses: Place the glasses downwards.



Cutlery

Use the dedicated basket. Place the cutlery randomly, preferably with the handle downwards, using caution to avoid injuries due to prongs of forks and blades of knives.

TOTAL PUMP-OUT AT THE END OF THE DAY

This is a drain and self-cleaning program with automatic shutdown.

Press the pump-out button for about 5", the Led flashes and the pump-out and automatic tank cleaning phase starts. The word **"UnLoad"** scrolls across the display. If the Led does not flash, the program has not been started and the boiler heating element is not on.

When pump-out is complete the appliance switches off (only 2 dots lit on the display)

After a total pump-out the filters should be cleaned as described in the relevant point.

Never switch the dishwasher off with water in the tank; always pump out first.

Topping up with regenerating salt (for models with softener)

| | | |
|--|--|--|
| | <p>Warning: use specific salt only, do not use cooking sea salt. Salt must be supplied when the led under the symbol indicated in the left side picture lights up. The salt container has a capacity of about 1 kg of granulated salt. The container is located on the bottom of the tank and it is fitted with two caps.</p> <p>A: screw cap - B: bayonet cap</p> <p>After extracting the basket, unscrewing cap A and extracting cap B, pour the salt using the provided funnel. Remove salt residues near the opening, if present, before placing the caps.</p> | |
| | | |
| | <p>Correct procedure to refill the regenerating salt:</p> <ul style="list-style-type: none"> - start a tank pump-out, - refill the regenerating salt, - fill the tank (FILL) - restart the tank pump-out - remove any salt residues from the bottom of the tank, as it may cause corrosion/rust. <p>This procedure prevents the washing water to enter the salt container (possible damage to the decalcifier) and that possible residues of salt are left in the tank (risk of corrosion/rust).</p> | |

9 MAINTENANCE AND CLEANING

Although no particular scheduled maintenance is required, users are advised to have the dishwasher checked by a specialist technician twice a year.

N.B.: the manufacturer accepts no liability for wilful damage or damage deriving from carelessness, neglect, failure to comply with instructions, regulations and standards or incorrect connections, which lead to forfeiture of warranty cover. If possible, leave the door ajar when not in use; Clean surfaces thoroughly and often with a damp cloth; use neutral, non-abrasive detergents which do not use chlorine compounds, which corrode and damage stainless steel. Do not use the products mentioned above even when cleaning the floor underneath or in the vicinity of the dishwasher, as vapours or drops may damage the steel surfaces.

| | |
|--|--|
| | <p>The dishwasher has IPX??? protection but pointing water jets straight at it for cleaning is forbidden</p> |
|--|--|

| | |
|--|--|
| | <p>Clean the outside of the appliance with a damp cloth and neutral soap, rinsing and drying thoroughly.</p> |
|--|--|

9.1 Daily cleaning of filters

The filter group is made of 2 or 3 filtering elements, according to the model.

Procedure to disassemble filters made of 3 filtering elements:

- a- Unfasten and remove the lower spray arm
- b- Lift and remove the two rectangular filters
- c- Rotate filter "C", lift it and separate it extracting the central part "D"

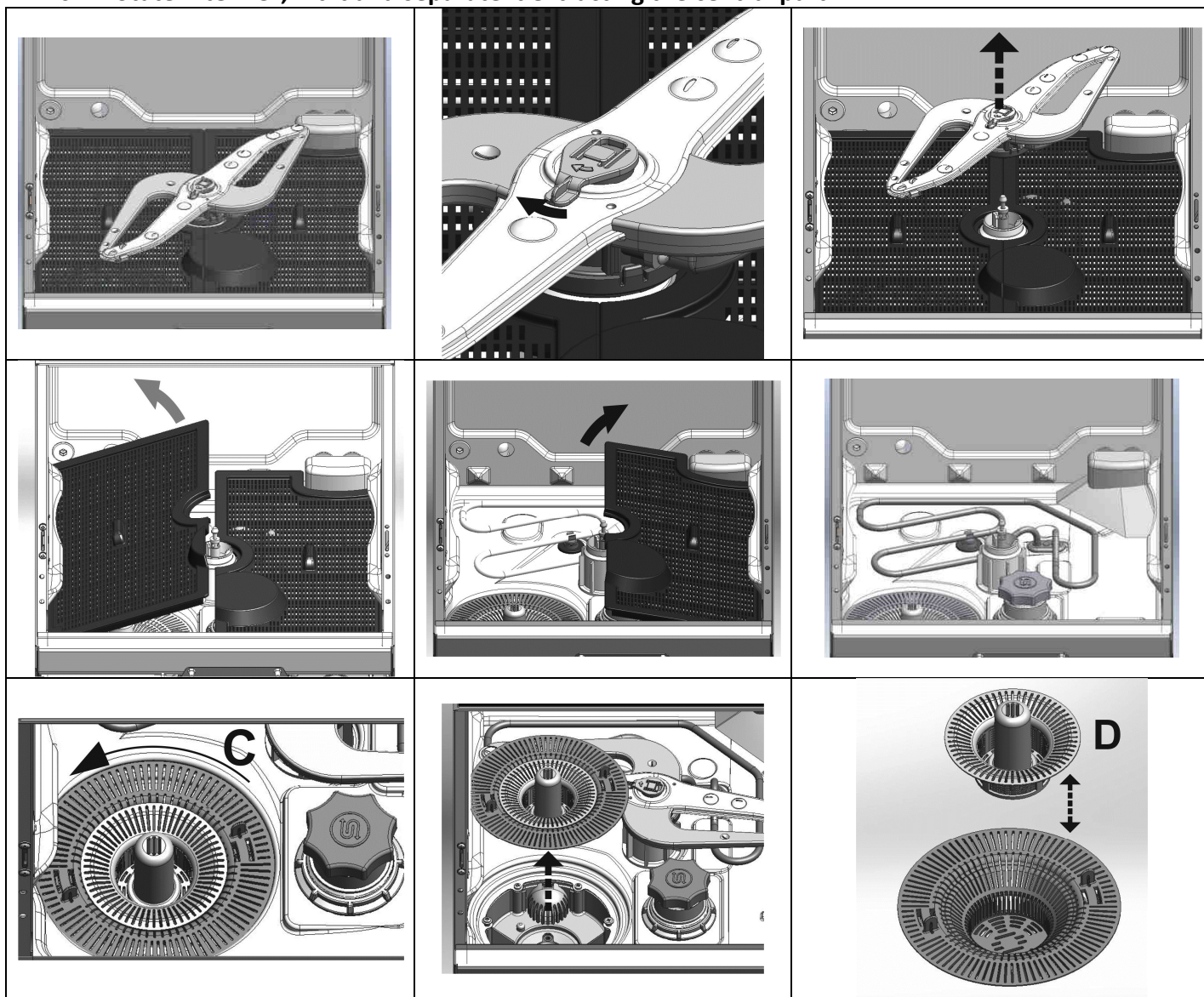

Procedure to disassemble the filters made of 2 filtering elements:

it is not necessary to remove the lower spray arm.

a- Rotate filter "C", lift it and separate it by extracting the central part "D"

Filter "C" can have different depths, according to the model.

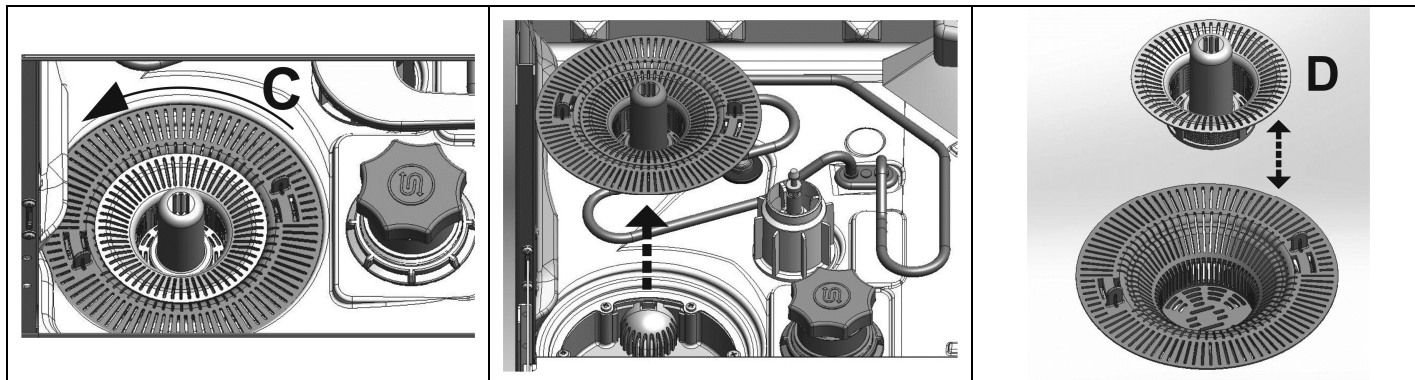

When removing the filters, do not let the coarse residues fall into the basin under the filters; clean and rinse them thoroughly, then re-insert them correctly; do not use sharp or pointed objects.

If present, clean any limescale deposit to prevent accumulation;

- When not in use, leave the door ajar if possible;

Clean the surfaces with a damp cloth accurately and frequently; use neutral, non-abrasive detergents, which do not contain chlorine based substances, or products that corrode and damage stainless steel.

Do not use the products described above to clean the floor under the dishwasher or near it, to prevent the steam or drops to damage the steel surfaces.

IMPORTANT: the dishwasher **automatically starts the "P0" program** at the beginning of the day, if **there is water left in the tank** and this is under the temperature of 40°C.

9.2 Routine inspection of the spray arms (once a week)

Remove the inferior and superior spray arms. Releasing the retaining element "R" is enough to remove them. Clean the spray arms with clean flowing water, **do not use tools which may cause damages.**

Reassemble the spray arms carefully.

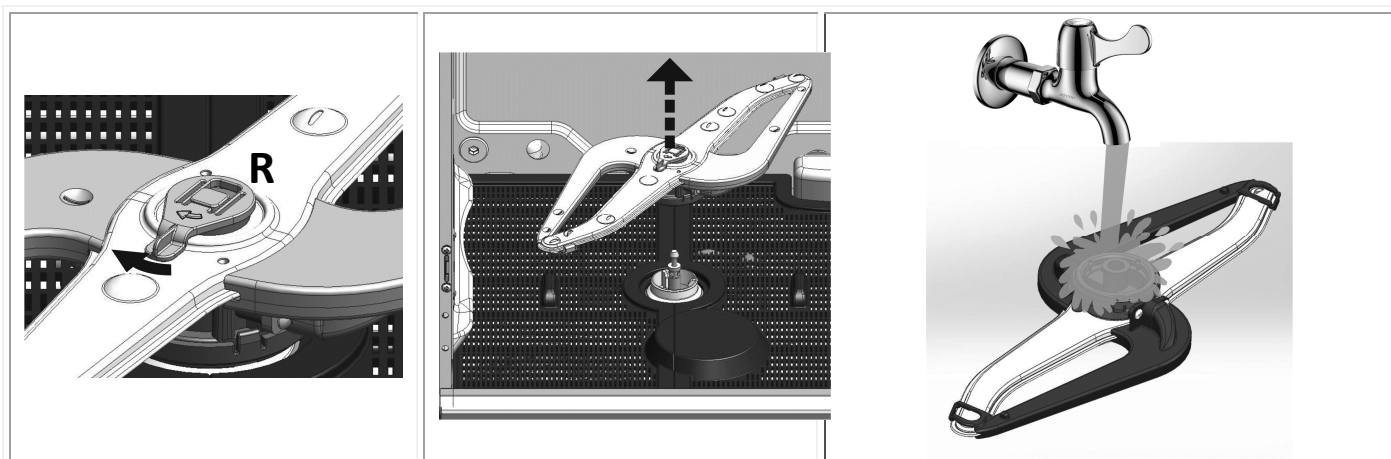

9.3 Lengthy periods out of use

If the dishwasher is to be out of use for a fairly long period of time, **the detergent and rinse aid dispenser devices must be emptied to prevent crystallisation and damage to the pumps**: Remove the intake hoses from the detergent and rinse aid containers and place them in a container of clean water, then perform a few wash cycles followed by a complete pump-out. Finally, turn off the master switch, close the water intake valve and leave the door ajar until the interior is completely dry. The detergent and rinse aid intake hoses must be put back into the containers when the dishwasher is returned to service, **taking care not to swap them over** (red hose = detergent, blue hose = rinse aid).

10 TROUBLESHOOTING

In case the pump is not working properly, follow the steps below:
 Empty the dishwasher out using a container and disconnect the power.
 Remove screw **A**, release tab **B** and lift it upwards.
 Make sure that the covered drain pump impeller can rotate freely, and that there are no dirt residues, limestone, or pieces of glass. Do not use tools, screwdrivers, scissors, etc.

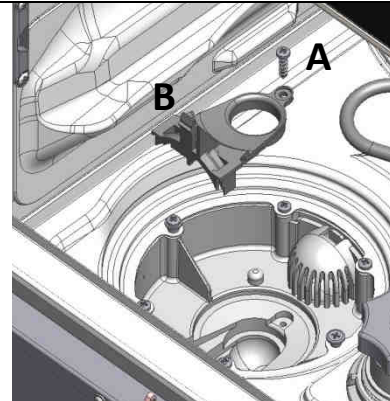

| PROBLEM | POSSIBLE CAUSE | POSSIBLE SOLUTION |
|--|--|--|
| THE INDICATOR LIGHT L1 DOES NOT LIGHT UP | line voltage failure | Verify electricity connection. |
| THE WASHING PROGRAM DOES NOT START | The dishwasher filling is not over yet. | Wait for FILL to disappear off the display |
| | CLOSE stays on display | If CLOSE stays even with the door closed, contact the After-Sales Service. |
| POOR WASHING RESULTS | Clogged or crusted spray arms holes. | Dismount and clean the spray arms (10.2 Periodical checks) |
| | Clogged filter | Read “cleaning the filters during the day” |
| | Insufficient or improper detergent or rinse aid. | Verify detergent type and quantity. |
| | Failing or insufficient use of detergent or rinse aid: the detergent or rinse aid cannot be withdrawn from the dedicated containers. | Worn or broken internal tube for detergent or rinse aid of the peristaltic pump, to be replaced by the After-Sales Service. This ordinary maintenance service is recommended at least once a year for the correct functioning of the dosers. |

| | | |
|--|---|---|
| | Badly positioned dishes / glasses. | Place dishes / glasses correctly. |
| | Low washing temperature | Verify the temperature displayed, if it is inferior than 50°C contact customer Support. |
| | Improper set cycle | Increase the duration of the washing cycle, especially if the load is very dirty or partially dried. |
| | Clogged nozzles Boiler incrustated with limescale | - Verify that the nozzles are clean and that the water softener, if present, is working correctly. - Verify that the filter of the tube placed inside the rinse aid jerrycan is not clogged. |
| INSUFFICIENT RINSE | Inappropriate rinse aid, or it is not dispensed correctly. Low rinsing temperature | Verify the rinse aid container and if it is adequate to the type of mains water. Verify the boiler set temperature Restore T Stop ON and/or connect the machine to hot water. If the problem is not solved, contact the After-Sales Service. |
| INSUFFICIENT DRYING | Inappropriate rinse aid, or it is not dispensed correctly. Water hardness superior than 12°dF or it contains many dissolved salts. | Verify the rinse aid container and if it is adequate to the type of mains water. If the problem is not solved, contact the After-Sales Service |
| STAINED GLASSES AND CUTLERY | Waste tube badly positioned or partially clogged. | Verify that the tube and drainage are not clogged and that the drainage is not positioned too high; see connection scheme. |
| WATER LEFT IN THE TANK AFTER PUMP-OUT. | Waste tube badly positioned or partially clogged. | Verify that the tube and drainage are not clogged and that the drainage is not positioned too high; see connection scheme. |

11 MALFUNCTIONS SHOWN ON THE DISPLAY (FOR THE USER)

The dishwasher can show a series of malfunctions on display.

After the machine has been switched off and restarted, if the problem is not solved, follow the steps below:

(FOR A MORE PROFICIENT AFTER-SALES SERVICE, ALWAYS TAKE NOTE OF THE INDICATED ERROR)

| | | |
|--------------|---|--|
| Err04 | Tank temperature probe anomaly | Contact After-sales Service |
| Err05 | Tank water filling anomaly | Check that the water supply tap is open, the dynamic supply pressure, cleanliness of the inlet water filter. If the problem still occurs, contact After-sales Service. |
| Err06 | Water pump-out anomaly (water remains in the dishwasher) | Check that the filters are clean, and that the drain pipe is not bent, obstructed, narrowed. Check that the drain pump is not blocked with a foreign body, follow steps indicated in "10.2 Periodical checks". If the problem still occurs, contact After-sales Service. |
| Err09 | Excessive water level in the tank anomaly | Contact After-sales Service |
| Err23 | Boiler heating anomaly (does not heat) | Contact After-sales Service |
| Err24 | Boiler temperature probe anomaly | Contact After-sales Service |
| Err25 | Boiler water filling anomaly | Check that the water supply tap is open, the dynamic supply pressure, cleanliness of the inlet water filter. If the problem still occurs, contact After-sales Service. |
| Err26 | Boiler emptying anomaly | Check that the nozzles of the rinsing spray arms are not clogged. If the problem still occurs, contact After-sales Service. |
| Err27 | Boiler emptying anomaly – with full tank | Contact After-sales Service |
| Err28 | Boiler heating anomaly (over temperature) | Contact After-sales Service |

INFORMATION AND AFTER-SALES SERVICE FOR SMEG PRODUCTS

COMMERCIAL DISHWASHERS

Our Sales Department staff will be able to provide you with information about prices and special offers.

Our After-Sales Department will be able to provide you with guidance about keeping your appliance functioning correctly and put you in touch with your nearest authorised Service Centre.

Our whole product offering can be viewed at:

www.smegfoodservice.com

International customers, please

contact your local SMEG distributor.

Smeg S.p.A.

Via Leonardo da Vinci, 4 - 42016 Guastalla (Reggio Emilia)

Tel. +39 0522 8211 - Fax + 39 0522 821453

email foodservice@smeg.it

| | |
|-----------------------|-------------------|
| <i>19.390.5956.00</i> | <i>16/11/2015</i> |
| Revision | Date |